



ARRIVING EARLY 2024

HULL #15 AUSTRALIAN PREMIERE

Full Specification

M-LINE

NEW | M48

PRESTIGE

TMG Yachts



DESIGN INNOVATION AWARD
SILVER AWARD - 2022



LOWER DECK – 3 STATEROOMS VERSION

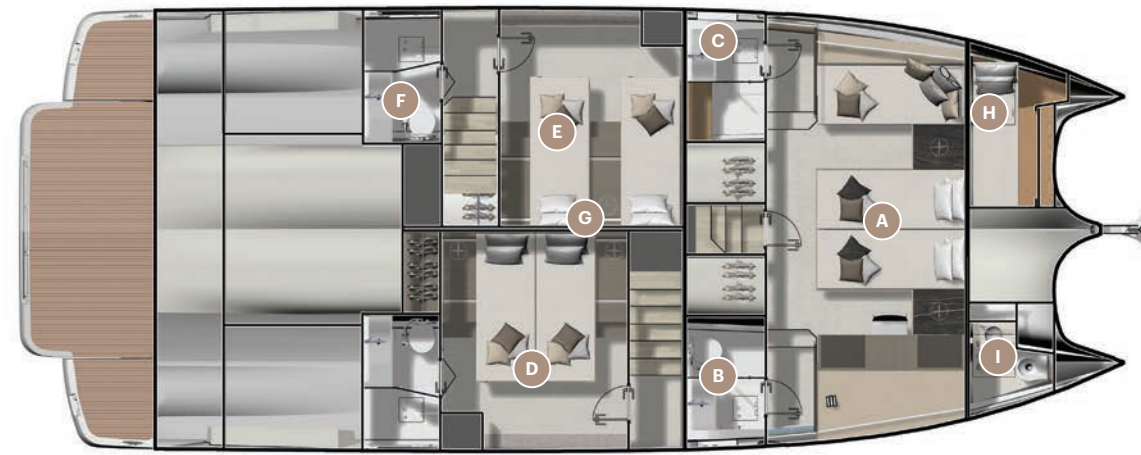

- A** Exceptional owner's suite
- B** Separate toilet with sink
- C** Private shower for the owner
- D** Guest stateroom with standard sliding beds and en-suite bathroom
- E** Guest stateroom with standard sliding beds and en-suite bathroom
- F** Day head
- G** Double wall with soundproofing foam
- H** Optional crew cabin
- I** Separate shower for the skipper

A UNIQUE OWNER'S SUIT

The owner's master suite in the M-48 is sublime, full beam and full headroom with head and bathroom on opposite sides. The master has a huge amount of light and air and there is even a forward window.



- 5m wide owner's suite
- A 180° view of the sea
- Plenty of storage space
- Direct access to the bathroom



OWNER'S SUITE: STORAGE FOCUS

- A** Shelves
- B** 5 drawers bureau
- C** Large drawer on each side of the bed
- D** Drawer under the sofa
- E** 2 bedside tables with drawer

BATHROOMS



TOILET AND SINK TO STARBOARD

- Owner's suite with direct access to the private bathroom
- Separate toilets
- Corian worktops with sink, Corian floor, lacquered furniture, backlit floating mirror



SHOWER AND SINK ON PORT SIDE



FINISHES

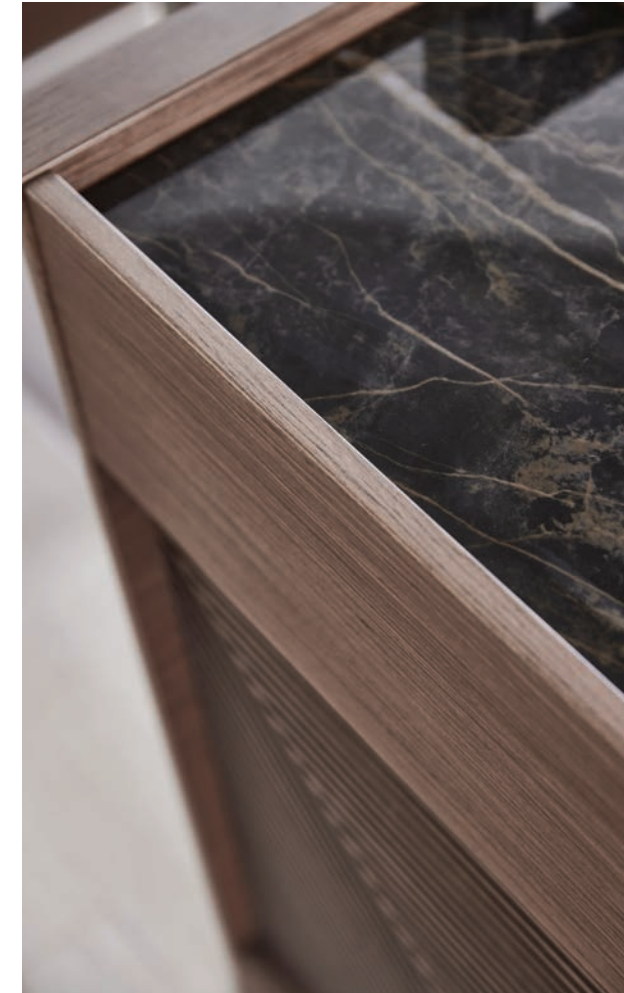

Interior Wood
Walnut / Noyer

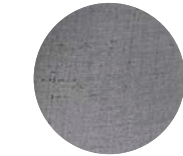

Interior Upholstery
Moulin Greige

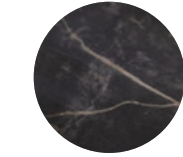

Upgrade Galley & Saloon Table
Laminam Noir Desir

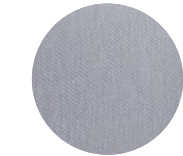

Exterior Upholstery
Glacier



Bathroom
Corian Hazelnut



Flooring
Flooring Fortezza



Flooring
Plush custom carpeting throughout

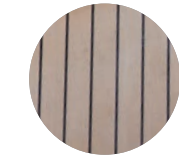

Flooring
Natural teak in cockpit and on flybridge



ART DE VIVRE PACKAGE



Villeroy & Boch Dishware

Glassware and flatware kit with Prestige logo (6 sets). This fine texture of this delicate white porcelain delights by its elegance, while being practical on a daily basis.



Full bedding and towel sets from Mona Lison

High-end organic cotton and wool fitted to each berth onboard. (see Prestige professional website for details)

A BREATHTAKING SEA VIEW



SALOON WITH LOWER HELM - WALNUT

INCLUDES

- A lounge as big as a 60-foot monohull!
- 360° vision: exceptional natural light and visibility thanks to panoramic windows
- Natural ventilation thanks to the 2 ceiling opening hatches and the side door
- Large bench seating in U-shape
- Convivial dining area for the whole family
- TV corner for relaxation
- Storage space as standard (instead of the interior helm station)



A CONVIVIAL GALLEY



A fully equipped, functional and user-friendly central galley:

- 3-burner induction cooktop (standard)
- Electric oven/microwave (standard)
- Dishwasher (option)
- Fridge (standard) with optional stainless steel fridge with larger capacity
- Laminam worktop (option)
- Lots of clever storage space

TRIM LEVEL EXCELLENCE



INCLUDES

- TRIM LEVEL "PREFERENCE"
- Volvo Joystick Docking
- Protective covers in the cockpit: sofas and wood tables
- Protective covers in the fly: sofas, pilot seat and console, wood table
- Inverter 2000W
- Grill and fridge in fly
- 11KVA generator

PLUS

- Multi-position central bathing platform
- Stern docking winch to starboard
- Freshwater/saltwater wash-down system
- Dock water inlet

HELM STATION



VERSION N°2: FLYBRIDGE HELM STATION

Interior helm station including:

- 2 windscreen wipers, windscreen defogger, 1 pilot seat with Dolce Black upholstery, Prestige leather steering wheel, dashboard with Volvo instrumentation and engine controls
- Electronic package for 2 stations in the hullhouse (2x 12" Garmin screens, VHF)

FOREDECK LOUNGE PACKAGE



INCLUDES

- Free standing sofa on foredeck
- Sunpad on foredeck
- Courtesy lights
- Sun awning with carbon fiber poles
- Protective covers set

A RELAXING AND COMFORTABLE SPACE

ELECTRONIC PACKAGES

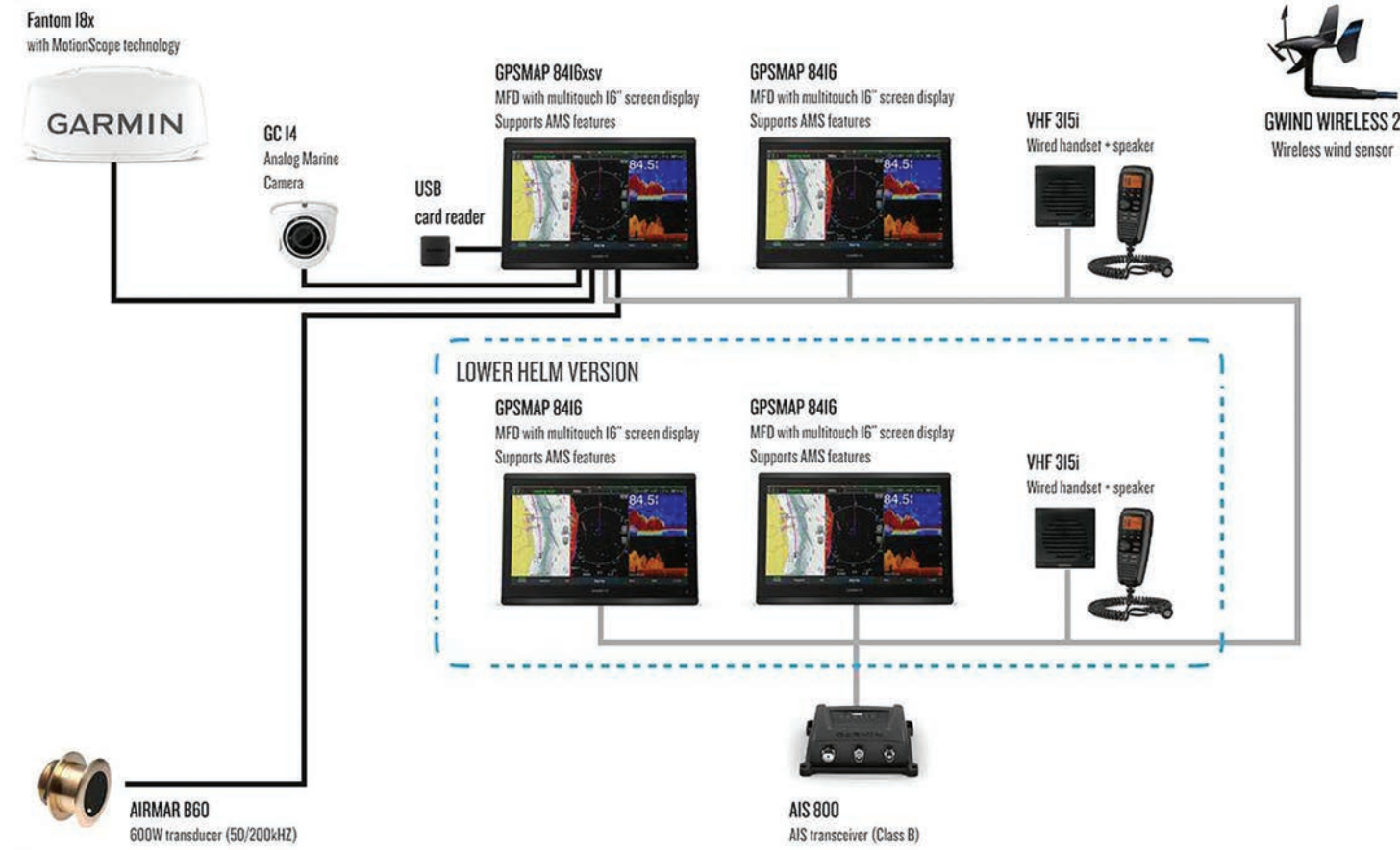

TROPICAL AIR CONDITIONING (SELF CONTAINED UNIT): 64 000 BTU

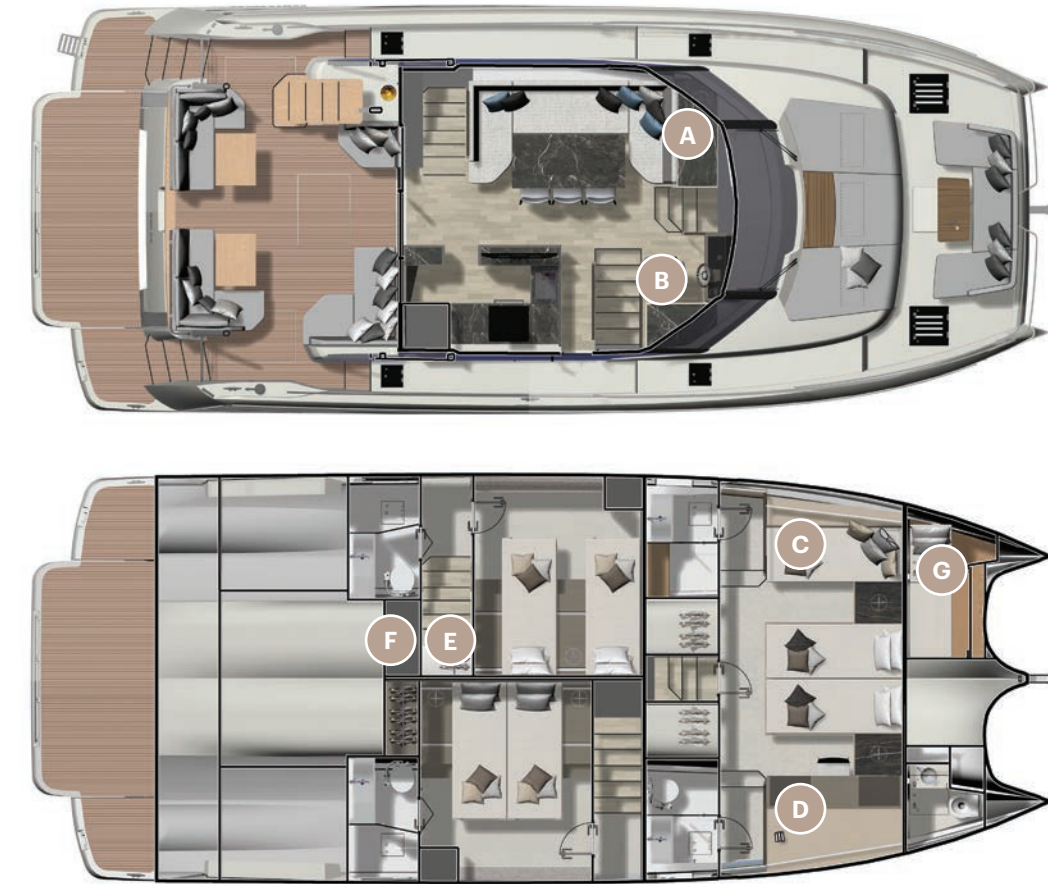

- A** Air handler 16 000 BTU
- B** Air handler 16 000 BTU
- C** Air handler 8 000 BTU
- D** Air handler 8 000 BTU
- E** Air handler 8 000 BTU
- F** Air handler 8 000 BTU
- G** Air handler 6 000 BTU

MAIN DECK – INTERIOR

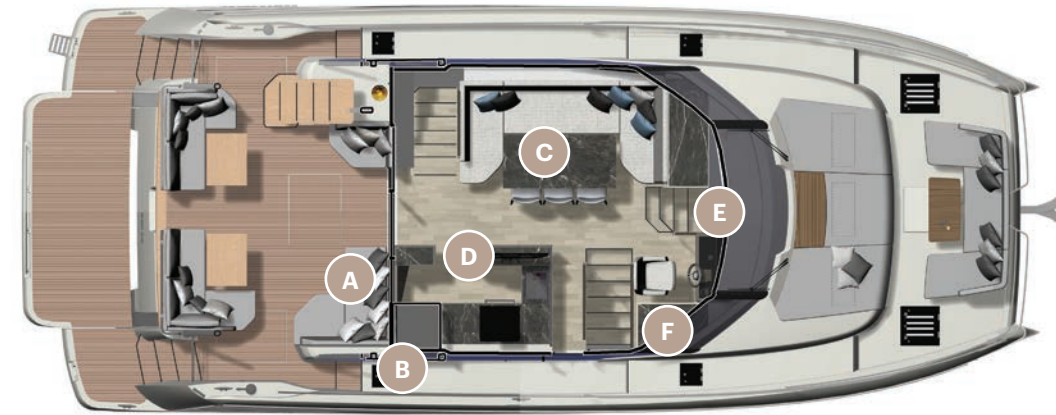

- A** Opening window between the galley and the cockpit
- B** Central galley fully-equipped
- C** Dining area for 6-8 people
- D** Pop-up TV cabinet (49")
- E** Direct access to master stateroom (only 3 steps)
- F** Interior cockpit or storage area, as desired

MAIN DECK – SMOOTH AND EASY CIRCULATION

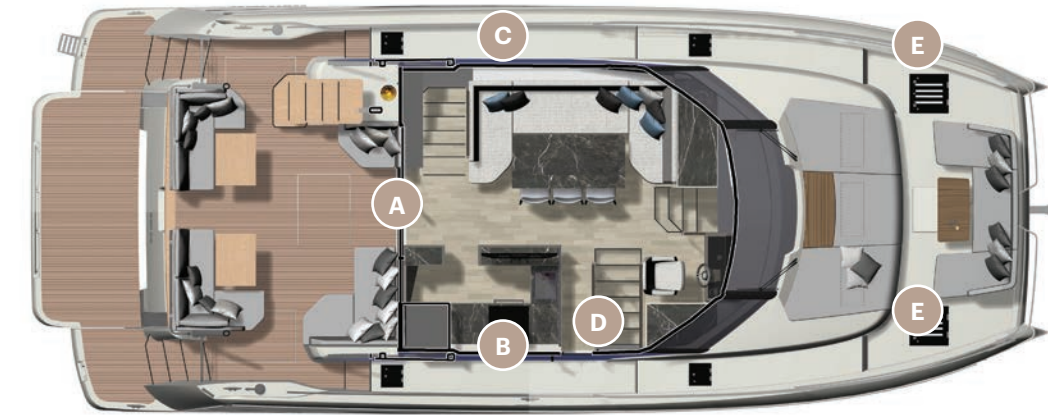

- A** Opening bay window between the galley and the cockpit
- B** Side door to access the side deck
- C** Large symmetrical side decks (45cm/148")
- D** Private stairs for each stateroom
- E** Access to the skipper cabin

EXCEPTIONAL TRANSOM EXPERIENCE



AN OPEN COCKPIT ALLOWING A GREAT CAPACITY OF WELCOMING AND CONVIVIALITY



- A Dining/relaxation area for 8pers
- B Ice maker in option
- C Lounge area oriented to the sea
- D 2 teak tables convertible into one large table

AN IMMENSE FLYBRIDGE



- Very large flybridge: 20 m² of living space
- Rigid Hardtop (in option)
- RODA outdoor furniture

FLYBRIDGE

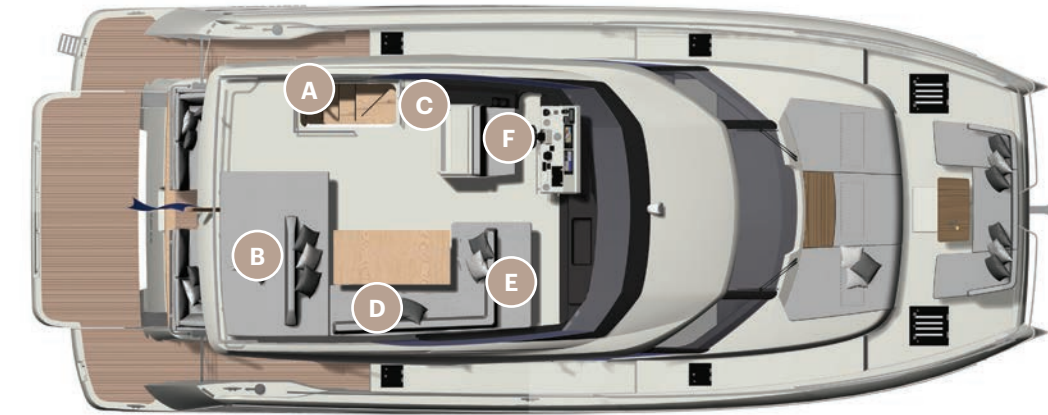

- A** Wide staircase – Gentle and safe slope from the cockpit
- B** Sunpad with adjustable backrest
- C** Galley, storage, in option: fridge (50L) and grill
- D** Convivial dining space can accommodate 6-8 people (with 2 additional chairs)
- E** Co-pilot area with double bench seat facing the navigation
- F** Fully equipped main steering station

COCKPIT – STORAGE FOCUS

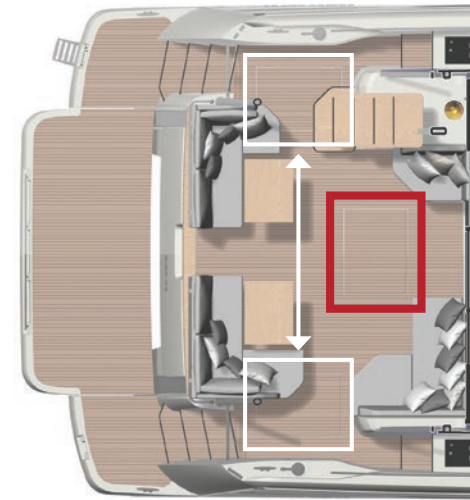

- 2 storage lockers above the engines (separating floor). Access from cockpit via 2 hatches port and starboard (see picture, white squares)
- Aft locker accessible from the cockpit via a central access (see picture, red square)

PERFORMANCE: V-DRIVE – CRUISING

PERFORMANCE: (CRUISING)

Speed (knots)	Engine RPM	Fuel Rate (L/h)	Fuel Rate (US Gal/h)	Efficiency (L/NM)	Efficiency (US Gal/NM)	Range (NM)
4,9	1000	4,3 l	1,1	,9l/miles	3,4	1333 NM
7,2	1500	10,9 l	2,9	1,5l/miles	5,8	789 NM
9,1	2000	23,6 l	6,2	2,6l/miles	9,8	463 NM
9,7	2200	32,3 l	8,5	3,4l/miles	12,7	358 NM
10,2	2400	40,2 l	10,6	4,0l/miles	15,0	303 NM
10,4	2500	45,7 l	12,1	4,4l/miles	16,6	273 NM
10,9	2600	51,3 l	13,6	4,7l/miles	17,9	254 NM
12,2	2800	62,1 l	16,4	5,1l/miles	19,4	235 NM
13,7	3000	71,3 l	18,8	5,2l/miles	19,7	231 NM
16,0**	3200	80,8 l	21,3	5,1l/miles	19,2	237 NM
18,5	3500	100,7 l	26,6	5,5l/miles	20,7	220 NM
19,4*	3600	111,5 l	29,5	5,8l/miles	21,8	208 NM



2 X VOLVO D4 320HP V-DRIVE



MID LOAD: 22 800KG



FULL



FULL

Performance will vary depending on sea conditions, water and air temperatures, cleanliness of hull and propellers and the loading of the vessel.

*Top Speed is 19+ kts with consumption of 111L/h

**Cruising Speed is 16 kts with a consumption of 80L/h

PRELIMINARY STANDARD EQUIPMENT

UPHOLSTERY

- Exterior upholstery Glacier
- Interior upholstery Dolce white

INTERIOR WOODWORK

- Walnut interior woodwork

DECK

- Stainless steel stem head fitting with anchor roller
- Anchor stop
- Electric windlass with wired remote in anchor locker (24 V)
- Windlass controls at lower helm and flybridge
- Anchor locker with dedicated space for fender storage
- Stainless steel cleats (8)
- Stainless steel handrails
- Foredeck sunpad area
- Storage compartment with dual access (from cockpit and bathing platform)
- Storage locker located under the cockpit, with electrically controlled access from the swim platform and cover in the aft cockpit
- Courtesy LED lights on sidedecks

BATHING PLATFORM

- Bathing platform
- Hot and cold shower
- Stainless steel bathing ladder

COCKPIT

- L-shaped sofa seating for two, with an additional central seat, by RODA
- 2 bench seats in the forward cockpit
- Folding cockpit table with cup holders
- Stainless steel ladder to flybridge with synthetic teak steps
- Access hatch to the engine room with gas struts
- Transom safety gate
- Lateral door in coaming
- 2 marine stereo speakers
- Overhead LED lighting
- Courtesy LED lighting

FLYBRIDGE

- Helm console with engine throttles and maneuvering joystick, compass, 12 V plug, cup holders and storage compartment
- Helm station bench
- Double bench seating at the helm by RODA
- Stainless steel guard rails
- Perspex windscreen
- Modular RODA furniture in the saloon and on the sundeck
- Table
- 2 marine stereo speakers
- Wetbar with sink
- Courtesy LED lighting

INTERIOR HELM STATION - OPTION (NO EXTRA COST)

- Helm console with engine throttles, full engine instrumentation, compass and cup holders
- Upholstered captain's chair
- Windscreen wipers with intermittent setting and washers
- Windscreen demister
- USB plugs
- Horn

SALOON

- U-shaped sofa seating
- Varnished table on stainless steel base
- Storage cabinet / TV stand to starboard
- 2 opening deck hatches in the ceiling
- Sliding lateral door to starboard
- Side window pleated blinds
- Handrails with hand stitched Foglizzo leather wrap
- Flooring through maindeck Fortezza
- Radio / CD / MP3 with Bluetooth in saloon
- 2 stereo speakers

GALLEY

- Stainless steel sink
- Mixing tap with pull-out sprayer
- Combination microwave / grill
- 3-zone induction cooktop
- Compact Volcanic countertop

- Fridge (178L / 47 US Gal) dual voltage
- Freezer (42L / 11 US Gal) dual voltage
- Waste bin
- Storage drawers and cupboards
- Galley island with storage
- Grey lacquer on galley doors
- Flooring through maindeck Fortezza

MASTER STATEROOM

- Independent access via private stairway
- Double bed (200 x 180 cm / 6'6" x 5'10")
- Mattress battens
- 2 reading lamps
- Bedside tables with storage
- Large closet with shelving
- Storage cabinet
- Desk with drawers and pouf
- Sofa
- Panoramic side windows with blinds, sheers and opening ports
- 2 skylights with opening sunshade
- AC and USB plugs
- En suite bathroom
- En suite toilets with basin
- Corian countertop, resin sink basin
- Soap dispenser & toothbrush holder
- Separate shower compartment
- Freshwater electric toilets
- AC plug
- Opening port
- Opening deck hatch with shade / insect screen

VIP STATEROOM

- Double bed (200 x 160 cm / 6'6" x 5'2") convertible into 2 single berths
- 2 reading lamps
- Bedside tables
- Large closet with shelving
- Panoramic side windows with blinds, sheers and opening ports
- Opening deck hatch with shade / insect screen
- AC and USB plugs

- En-suite bathroom access via pocket door
- Corian countertop, resin sink basin
- Soap dispenser & toothbrush holder
- Separate shower compartment
- Freshwater electric toilets
- AC plug
- Opening port

GUEST STATEROOM

- 2 single berths (200 x 160 cm / 6'6" x 5'2") convertible in double berth
- Reading lamp
- Bedside table with storage
- Large closet with shelving
- Panoramic side windows with blinds, sheers and opening ports
- AC and USB plugs
- En suite bathroom
- Corian countertop, resin sink basin
- Soap dispenser & toothbrush holder
- Separate shower compartment
- Freshwater electric toilets
- AC plug
- Opening port

CREW ACCOMMODATION - OPTION

- Single berth (200 x 72 cm / 6'6" x 24)
- Storage closet
- Separate bathroom with toilet, washbasin and shower
- Access via the deck hatches at the bow

PROPULSION

- Twin engine V-Drive system
- VOLVO joystick for V-Drive transmission
- Bow thruster 24 V dual prop (250 Kg / 551 lb)
- Forced air ventilation system for engine room

ELECTRICAL SYSTEM

- Battery bank 12 V - Engine (200 A/h)
- AGM Battery bank 12 V - House (400 A/h)
- Battery bank crossover switch at helm

- Seanapps: connected box + mobile application for monitoring safety, navigation data, maintenance and comfort on board
- Tactile graphic display for battery levels, AC sources, lighting and tank levels
- Remote battery switches
- Centralized distribution and breaker boxes for AC and DC systems
- AC shore power system
- Twin battery chargers 2 x 40A - 24 V
- LED interior and exterior lighting with dimmer switches
- AC plugs in each cabin and in the galley and saloon

FUEL SYSTEM

- 2 fuel tanks (aluminum) with interconnection valves - 1200 L / 317 US Gal
- Fuel fills to port and starboard

WATER SYSTEM

- Freshwater tanks 600 L / 159 US Gal
- Hot water heater 60 L / 16 US Gal
- Freshwater pressure pump
- Grey water sump pump with automatic discharge
- Holding tank 170 L / 45 US Gal
- Holding tank vent filters
- Overboard discharge pumps for holding tanks with macerator function and deck pump-out
- Automatic bilge pumps (4) with high water alarm

SYSTEMS

- Automatic fire extinguishers in engine room with control at each helm (Novac 1230)

CONSTRUCTION

- Hand-laid GRP hull
- Hand-laid GRP deck with counter molding
- Infused GRP hull with longitudinal infused stringers
- Infused GRP deck with counter molding
- Isophthalic gelcoat
- Osmosis barrier
- Infused structural bulkheads

ADDITIONAL STANDARD EQUIPMENT

- User and Owner's manuals

NORTH AMERICAN SPECIFICATIONS

- Air conditioning with reverse cycle heating (64 000 BTU)
- Generator with underwater silent exhaust (13,5kW)
- Glendinning cable management system
- AGM Gel batteries bank upgrade
- Galvanic Isolator
- Cathodic bonding system with dedicated anodes
- Fusion Apollo Audio system in salon, cockpit and flybridge
- Fusion Apollo Audio system in owner's cabin
- 50" TV pre wiring in salon with lift
- 32" TV pre wiring in owner's cabin
- Mooring kit
- Side boarding gate on port
- Flybridge Kenyon grill and fridge
- Dock water inlet with regulator
- Fresh water deck wash pump
- Stainless steel fridge in galley
- Safe in owner's cabin

PRESTIGE M48

PRICING IN AUSTRALIAN DOLLARS INCL GST. CURRENT AS AT 1ST JANUARY 2023

Layout Configuration:	\$2,590,000	
Factory Fitted Options:	\$606,502	
Retail Price:	\$3,196,502	
STANDARD INCLUSIONS		
Antifouling, rigging and commissioning of yacht	Standard	
Insurance covered from factory until completion of commissioning	Standard	
PROPULSION		
Prestige M48 2x Volvo D4 320 (2x320 CV) V Drive	\$2,590,000	Yes
LAYOUT		
Storage in bow compartments port and starboard – Standard	Standard	Yes
Interior woodwork 3 cabins/3 bathrooms – Walnut	Standard	Yes
OTHER VERSIONS		
LOWER HELM VERSION – WALNUT WOODWORKS		
Includes:		
<ul style="list-style-type: none"> • Helm console • Engine throttles • Engine instruments • Compass • 2 windscreen wipers • Windscreen demister • Adjustable helm seat • Cupholder 	Standard	Yes

PRICING IN AUSTRALIAN DOLLARS INCL GST. CURRENT AS AT 1ST JANUARY 2023

UPHOLSTERY		
Upholstery Moulin Greige	\$2,707	Yes
TRIM LEVEL		
TRIM LEVEL PREFERENCE		
Includes:		
<ul style="list-style-type: none"> • Volvo Joystick Docking • Protective covers in the cockpit: sofas and wood tables • Protective covers on the fly: sofas, pilot seat and console, wood table • Inverter 2000W • Grill and fridge on the fly • Generator with silent exhaust 	\$121,978	
TRIM LEVEL EXCELLENCE INCLUDES:		
TRIM LEVEL “PREFERENCE”		
<ul style="list-style-type: none"> • Volvo Joystick Docking • Protective covers in the cockpit: sofas and wood tables • Protective covers on the fly: sofas, pilot seat and console, wood table • Inverter 2000W • Grill and fridge on the fly • Generator with silent exhaust 	\$210,062	Yes
PLUS:		
<ul style="list-style-type: none"> • Multi-position central bathing platform with resin teak and flush mounted tender cradle • Stern docking winch to starboard • Freshwater/saltwater wash-down system • Dock water inlet 		



PRICING IN AUSTRALIAN DOLLARS INCL GST. CURRENT AS AT 1ST JANUARY 2023

OPTIONS		
Exterior Upholstery Glacier	Standard	Yes
FOREDECK LOUNGE PACKAGE FOR GLACIER EXTERIOR UPHOLSTERY Includes: <ul style="list-style-type: none"> Free standing sofa on the foredeck Sunpad on the foredeck Courtesy lights Sun awning with carbon fiber poles Protective covers set 	\$42,450	Yes
ART DE VIVRE PACKAGE 3 CABINS VERSION Includes: <ul style="list-style-type: none"> Villeroy & Boch dishware, glassware and flatware kit – 6 sets Full bedding in high-end organic cotton and wool from Mona Lison Towel sets in high-end organic cotton from Mona Lison 	\$20,444	Yes
ELECTRONIC PACKAGE VERSION 2 HELM AT FLY AND WHEELHOUSE Includes: <ul style="list-style-type: none"> 2 multifunction 12" Screens at lower helm 2 multifunction 16" Screens on Fly VHF Garmin dual Station Garmin autopilot Volvo interface Stainless steel radar mount Fantom 18 radar Garmin AIS Rear camera Garmin wind indicator 	\$71,056	Yes

PRICING IN AUSTRALIAN DOLLARS INCL GST. CURRENT AS AT 1ST JANUARY 2023

OPTIONS		
Mooring kit	\$3,196	Yes
Anchoring kit	\$4,893	Yes
Port side boarding gate	\$6,622	Yes
Flybridge hard top	\$41,971	Yes
Deck searchlight	\$1,519	Yes
Underwater lights – multicolored	\$12,324	Yes
220V/50Hz washing machine and tumble dryer	\$5,361	Yes
Dishwasher	\$3,311	Yes
Air conditioning tropical – 64,000 BTU	\$79,216	Yes
Table and galley counter tops – Laminan Noir Desir	\$12,116	Yes
Pre-Installation TV 32" in owners cabin	\$2,310	Yes
Teak decking in cockpit	\$53,066	Yes
Teak decking on flybridge	\$33,880	Yes



JOHN COWPE

TMG YACHTS MANAGING DIRECTOR

+61 (0) 405 409 686

www.tmg-yachts.com

john@tmgyachts.com





PRESTIGE

TMG Yachts



DESIGN INNOVATION AWARD
SALON NAUTIQUE - GENÈVE
S&Y

